



ADDENDUM NO. 3

March 19, 2010

TO: ALL BIDDERS

PROJECT: REDEVELOPMENT AGENCY FOR THE COUNTY OF RIVERSIDE
PERRIS VALLEY – BIG LEAGUE DREAMSMIG, INC.
801 N. HARBOR BLVD
FULLERTON, CA 92832

THIS ADDENDUM IS ISSUED AS PART OF THE CONTRACT DOCUMENTS FOR THE ABOVE MENTIONED PROJECT AND AMENDS ONLY THOSE ITEMS SPECIFICALLY DEFINED HEREIN. PLEASE UPDATE YOUR SPECIFICATIONS WITH THE FOLLOWING INFORMATION:

DRAWINGS/SPECIFICATION:ITEM NO. 1:

Due to limited availability of proposed boulder "Artisian" available through KRC Rock, the boulder has been changed to "Desert Gold" available through KRC Rock. Attached is specification section 02960-Rockwork for reference.

ITEM NO. 2:

Proposed Bioclean Baffle Box unit shown on Civil Sheet C3.1 note #22a has been revised to reflect the applicable size needed for this project. Attached is revised drawings C3.1 and detail drawings C3.01 for reference.

ITEM NO. 3:

The following notes on Street Improvement Plans are provided for clarification
Sheet 1 of 16 – Street Improvement Title Sheet

Note #1 – The Owner will be responsible for encroachment permits

Note #5 – This is the responsibility of the contractor.

Note #9 – This is the responsibility of the contractor.

ITEM NO. 4:

Outfield Wall Graphics - Contractor shall include in bid price a cost for the outfield wall graphics. Price shall include the design, printing and installation of wall graphics for Yankee, Angel, Fenway and Dodger Stadiums. Contact-James Swanson at Screaming Images (323)533-0543



ITEM NO. 5:

Site Furnishings clarification - Contractor shall provide the following quantities:

Picnic Tables – A total of (30) required, (10) must be ADA accessible tables

Trash Receptacles – A total of (20) required.

Other amenities are listed on plans and specifications.

These two items are contractor supplied and contractor installed. Direction will be given to contractor as to the placement of said items by Big League Dreams and/or Landscape Architect at time of installation.

ITEM NO. 6:

Arena Soccer Dasher System Clarification – Detail A, Sheet LD-5.1;

Score/Time Keeper's area shall have protection from soccer balls. Provide 8' high wall (48" high plastic and 48" tempered glass panel) as part of the dasher wall system in front of the score/time keeper's table, also provide 48" high plastic wall at back of keeper's area.

Also provide 48" high plastic wall in front of player's area. Refer to attached drawing.

ITEM NO. 7:

Ballfield Equipment Clarification – Contractor shall include in bid price the following totals for equipment for the ballfields:

Pitching Rubbers – 18

Home Plate - 6

Single Bases – 23

Double Bases - 12

Base Anchors – 96

ITEM NO. 8:

Revised Water Construction Notes per RFI #38. Refer to sheet PGP C1.0 and SW and WA sheets C4.1 thru C4.6.

ITEM NO. 9:

Addendum #2 Acknowledgement - Contractors to replace acknowledgement page found on Addendum #2 with new acknowledgement sheet provided in this addendum.



ACKNOWLEDGEMENTS

The bidder, in submitting the bid, shall acknowledge in the bid documents submitted the receipt of this Addendum. Should an acknowledgement not be made in the bid, the bid will not be considered by the County.

Bidder's Certificate: This certificate must be signed and returned together with the bid proposal, otherwise the submitted bid shall be considered incomplete.

I ACKNOWLEDGE RECEIPT OF THIS ADDENDUM #3 AND I ACCEPT THE AFOREMENTIONED CONDITIONS.

DATE: _____

COMPANY: _____

SIGNATURE: _____

TITLE: _____

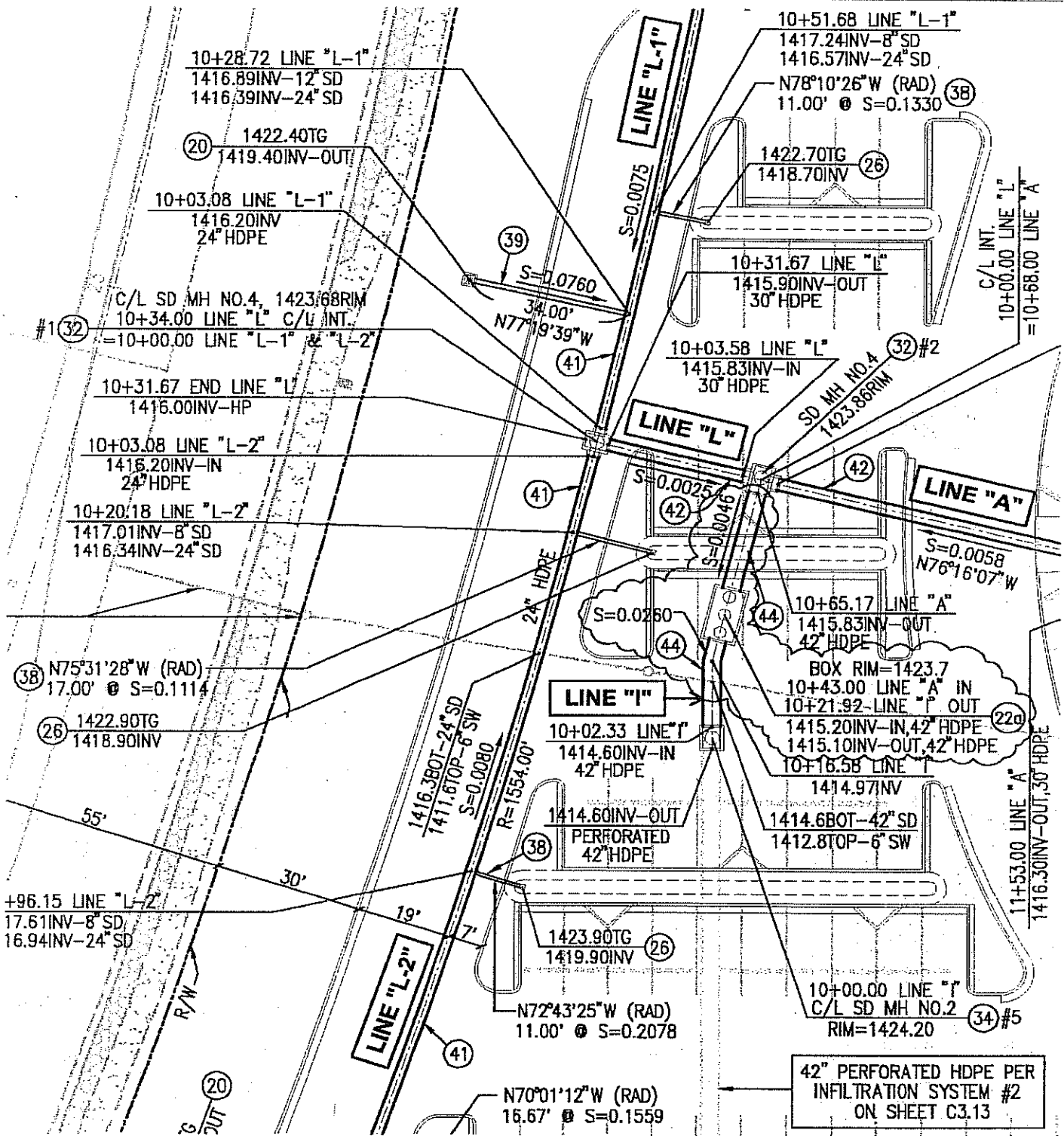

STORM DRAIN CONSTRUCTION NOTE

22a CONSTRUCT BAFFLE BOX MODEL NO. NSBB 6-12-B4 BY BIOCLEAN PER DETAIL #22a ON SHEET #2 OF 2 (OR APPROVED EQUAL). CONTRACTOR TO COORDINATE WITH MANUFACTURER.

NOTE:
SEE FULL SIZE SHEETS C1.0 AND C3.1
FOR ADDITIONAL CONSTRUCTION NOTES



SCALE: 1"=30'

ADDENDUM #3
SD SHEET C3.1-REVISED BIOCLEAN
BAFFLE BOX SIZE
DATE 3-17-10
SHEET 1 OF 2

PERRIS VALLEY BIG LEAGUE DREAMS
2155 TRUMBLE ROAD
PERRIS, CALIFORNIA 92570

MOORE IACOFANO GOLTSBMAN, INC.
801 N. HARBOR BLVD.
FULLERTON, CA 92632
TEL 714/971-3022
FAX 714/971-1104
WWW.MIGI.COM

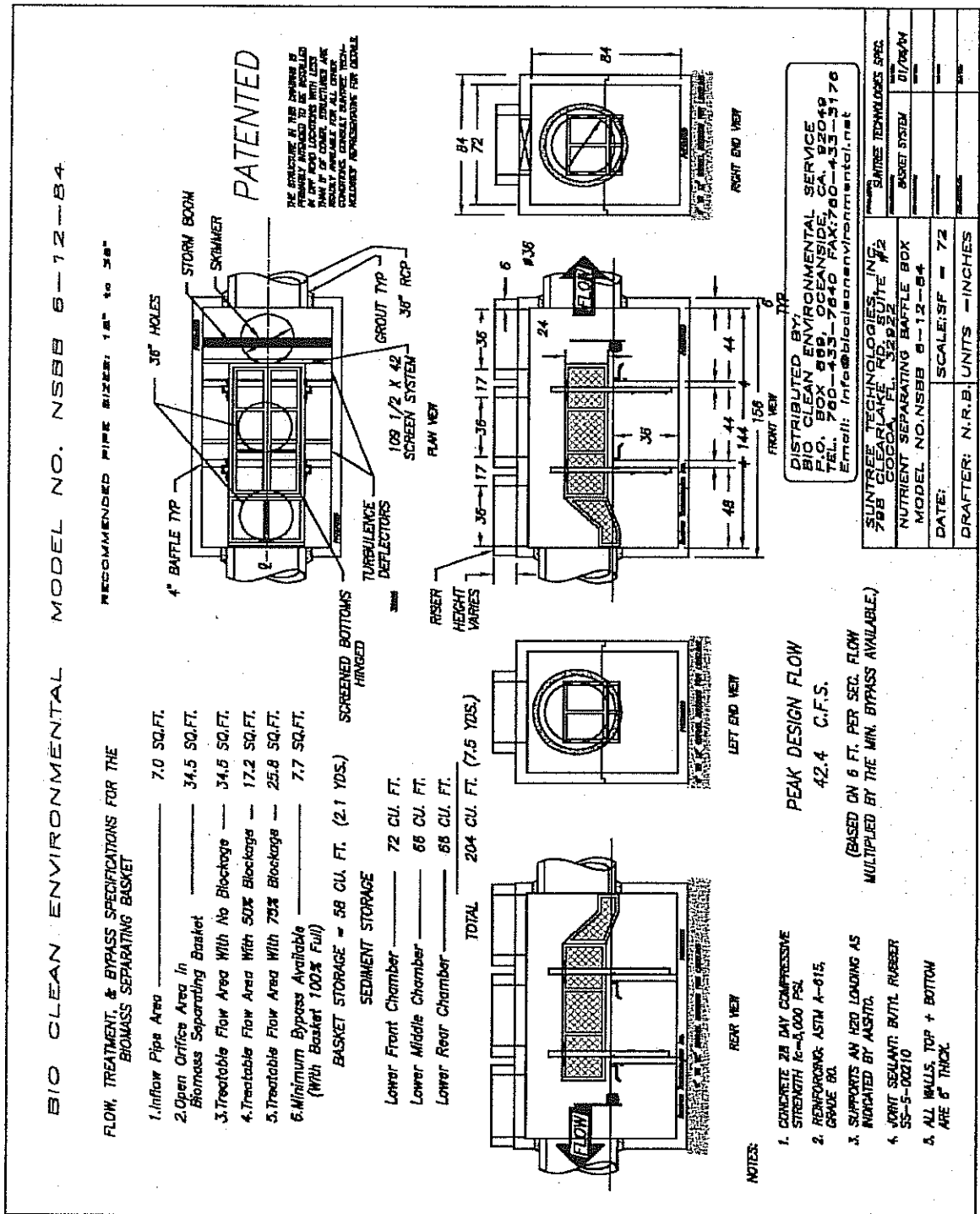

STORM DRAIN CONSTRUCTION NOTE

22a) CONSTRUCT BAFFLE BOX MODEL NO. NSBB 6-12-84 BY BIOCLEAN PER DETAIL #22a HEREON (OR APPROVED EQUAL). CONTRACTOR TO COORDINATE WITH MANUFACTURER.

NOTE:
 PLAN VIEW ON SHEET 1,
 AND FULL SIZE SHEET C3.1

ADDENDUM #3
 SD SHEET C3.01-REVISED
 BIOCLEAN BAFFLE BOX SIZE
 DATE 3-17-10
 SHEET 2 OF 2

PERRIS VALLEY BIG LEAGUE DREAMS
 2155 TRUMBLE ROAD
 PERRIS, CALIFORNIA 92570

MOORE IACOFANO GOLDBMAN, INC.
 871 N. HANCOCK ST.
 FULLERTON, CA 92832
 TEL: 714/871-2038
 FAX: 714/871-1158
 www.migol.com

CLARIFICATIONS TO STREET GENERAL NOTES:

NOTE #1 - THIS IS TO CLARIFY THAT OWNER WILL BE RESPONSIBLE FOR ENCROACHMENT PERMITS.

NOTE #5 - THIS IS TO CLARIFY THAT THIS IS CONTRACTOR'S RESPONSIBILITY.

NOTE #9 - THIS IS TO CLARIFY THAT THIS IS CONTRACTOR'S RESPONSIBILITY.

POTHOLING RESPONSIBILITY:

CONTRACTOR TO POTHOLE AND VERIFY LOCATION OF EXISTING UTILITIES AT JOINS AND CROSSINGS PRIOR TO BEGINNING CONSTRUCTION, AND NOTIFY ENGINEER OF ANY CONFLICTS (ALSO AS NOTED IN THE SPECIFICATIONS).

ADDENDUM #3
STREET PLANS TITLE SHEET, SHEET 1 OF
18 - CLARIFICATIONS TO STREET GENERAL
NOTES.
DATE 3-17-10
SHEET 1 OF 1

PERRIS VALLEY BIG LEAGUE DREAMS
2155 TRUMBLE ROAD
PERRIS, CALIFORNIA 92570



MOORE IACOFANO GOLTSMAN, INC.
811 N. HANCOCK DE WIL
FALLERTON, CA 92582
TEL. 714/971-5034
FAX 714/971-1108
www.migolts.com

REVISED WATER CONSTRUCTION NOTES (PER RFI #38)

- (50) CONSTRUCT 4" PVC AWWA C-900, CL150 PIPE ~~WITH TRACING WIRE PER E.M.W.D. STD. DWG. B-533 & B-656.~~ PIPE BEDDING PER E.M.W.D. STD. DWG. B-408, AND TRENCH BACKFILL PER E.M.W.D. STD. DWG. B-286B.
- (51) CONSTRUCT 3" PVC PIPE, CL200 ~~WITH TRACING WIRE PER E.M.W.D. STD. DWG. B-533 & B-656.~~ PIPE BEDDING PER E.M.W.D. STD. DWG. B-408, AND TRENCH BACKFILL PER E.M.W.D. STD. DWG. B-286B.
- (52) CONSTRUCT 2 1/2" PVC PIPE, CL200 ~~WITH TRACING WIRE PER E.M.W.D. STD. DWG. B-533 & B-656.~~ PIPE BEDDING PER E.M.W.D. STD. DWG. B-408, AND TRENCH BACKFILL PER E.M.W.D. STD. DWG. B-286B.
- (53) CONSTRUCT 2" PVC PIPE, CL200 ~~WITH TRACING WIRE PER E.M.W.D. STD. DWG. B-533 & B-656.~~ PIPE BEDDING PER E.M.W.D. STD. DWG. B-408, AND TRENCH BACKFILL PER E.M.W.D. STD. DWG. B-286B.
- (54) CONSTRUCT 1 1/2" PVC PIPE (SCH 40) ~~WITH TRACING WIRE PER E.M.W.D. STD. DWG. B-533 & B-656.~~ PIPE BEDDING PER E.M.W.D. STD. DWG. B-408, AND TRENCH BACKFILL PER E.M.W.D. STD. DWG. B-286B.

ADDENDUM #3

PGP SHEET C1.0, AND SW & WA SHEETS
C4.1 THRU C4.8 - REVISED WATER
CONSTRUCTION NOTES
DATE 3-17-10
SHEET 1 OF 1

PERRIS VALLEY BIG LEAGUE DREAMS
2155 TRUMBLE ROAD
PERRIS, CALIFORNIA 92570



MOORE IACOFANO GOLTSMAN, INC.
801 N. HANCOCK BLVD.
FALLS CHURCH, VA 22042
TEL. 714.871.3016
FAX 714.871-1128
www.migcon.com

SECTION 02960
ROCKWORK

PART 1 - GENERAL

A. Scope of Work:

1. Furnishing and installing natural stone/rock, veneer, paving and cobble groundcover where shown on drawings.

PART 2 - MATERIALS

A. Rock Cobble:

Rock cobble shall be rounded river rock selected for appearance and durability. Quality of stone shall meet the requirements of Section 200-1.6 of the Standard Specifications.

1. Product Name: Riverside Cobble, mfg: KRC Rock (760)744-1036 Color: light grays, very smooth and rounded rustic cobble. Size: (2"-4"), palletized. Geology: Granitic in origin
2. Approximate extent of rock cobble is shown on the drawings. Rockwork symbol on the drawings illustrates area of surface to be covered with rockwork. It does not indicate the actual number of rocks to be placed. Major rock sizes are indicated on drawings.

B. Rock Boulders:

Rock boulders shall be angular quarried rock selected for appearance and durability. Quality of stone meet the requirement of:

1. Product Name: "Desert Gold", mfg: KRC Rock, Ph 760-744-1036. Color: Rich gray base overlaid with a rust brown finish. Size: various from (3')(4')(5')(6'). Geology: Granitic in origin
2. Approximate extent of rock boulders shown on the drawings. Rockwork symbol on the drawings illustrates area of surface to be covered with rockwork. Major rock sizes are indicated on drawings.

C. Rock Flagstone Paving:

Flagstone Paving shall be angular quarried rock selected for appearance and durability. Quality of stone meet the requirement of:

1. Product Name: "Blackgold", mfg: KRC Rock, Ph 760-744-1036. Color: rich tan and blackish gray tones. Size: varies. Thickness: min. 2"
2. Approximate extent of Flagstone Paving shown on the drawings. Rockwork symbol on the drawings illustrates area of surface to be covered with rockwork.
3. Flagstone shall meet all ADA requirements for acceptable lifting tolerances between stone and grout. Contractor shall be responsible for all unacceptable work, including, but not limited to, removing all unacceptable work, replacing material, installation of new work and any special inspection that may be required to meet ADA guidelines and specifications.

D. Stone Veneer:

Stone veneer shall be angular quarried natural rock selected for appearance and durability. Quality of stone shall meet the requirement of:

1. Product Name: McGregor Lake Thin Veneer, mfg: KRC Rock, product #: 12VNR2790, Ph 760-744-1036. Color: Dark Rustic bronze and earth tones. with a rust brown finish. Size: various
2. Provide complementing Thin Veneer Corners: McGregor Lake, mfg: KRC Rock, product #: 12VNR2657, ph. 760-744-1036.
3. Approximate extent of stone veneer shown on the drawings. Rockwork symbol on the drawings illustrates area of surface to be covered with rockwork. It does not indicate the actual number of rocks to be placed

E. Grout:

1. Grout shall conform to the requirements of Section 201-1 and shall be Class 560-C-3250 with 5 inch maximum slump. The concrete mixture shall be modified so that the quantity of coarse aggregate in the mix larger than pea gravel size is one-half the amount required for Class C P.C.C. as specified in Section 201-1.3.2 of the Standard Specifications.
2. Seeded pea gravel: 3/8" Birdseye Brown #45BLK0811, mfg: KRC Rock, ph. 760-744-1036, colors: dark browns with hints of yellow and grays.
2. Color shall match stone veneer. Submit colors to Landscape Architect for final approval before commencing work.

PART 3 - EXECUTION

A. Rock/Stone:

1. Rock shall be transported and handled in a manner to prevent scarring, chipping, flaking and breakage.
2. The Owner's Construction Manager shall be notified 48 hours prior to placing of rock and will be present to provide direction during this operation. The Owner's Construction Manager's opinion concerning the aesthetic placement of boulders shall be final. No additional compensation will be allowed for operations required to satisfy the Construction Manager's artistic judgment.
3. Rock boulders at the base of rock formations and at shoreline areas shall be buried at least 1/4 of their total mass, and shall be positioned to resemble natural occurrence.
4. Rock boulders shall have no sharp edges or protrusions exposed above subgrade.
5. Stacked boulders shall be placed so that no tilting or rocking of any boulder occurs. Boulders shall be firmly butted against each other, and wedged when possible.
6. All stacked boulders shall be firmly grouted together. All voids between rocks shall be filled. Surface of grouting shall be left rough.

7. Contractor shall coordinate off-haul and crane with rock manufacturer.

B. Sealer/Enhancer:

1. All stone shall be sealed with a low-gloss natural stone sealer specially formulated for use on natural stone. Sealer shall be non-yellowing acrylic that provides protection against oil, water and acid.
2. Sealer shall be a film forming, water based sealer.
3. Contractor shall provide Landscape Architect a finish color sample for final approval prior to commencing work. Sample can be on finish work in an inconspicuous area.
4. Contractor to follow all written manufacturer's recommendation for applying, handling, preparation and coverage of product on all surfaces.

END OF SECTION 02960



ACKNOWLEDGEMENTS

The bidder, in submitting the bid, shall acknowledge in the bid documents submitted the receipt of this Addendum. Should an acknowledgement not be made in the bid, the bid will not be considered by the County.

Bidder's Certificate: This certificate must be signed and returned together with the bid proposal, otherwise the submitted bid shall be considered incomplete.

I ACKNOWLEDGE RECEIPT OF THIS ADDENDUM #2 AND I ACCEPT THE AFOREMENTIONED CONDITIONS.

DATE: _____

COMPANY: _____

SIGNATURE: _____

TITLE: _____

